

P.C.B. LAYOUT

**MATERIALS:**

1. Housing: PBT (UL 94V-0), Black / Green
  2. Contacts: Brass
  3. Shell: SPCC
  4. Rivet: Copper Alloy (Lead  $\leq$  40000PPM)
  5. Board Lock: SPCC
  6. Screw: SPCC
- Or Copper Alloy (Lead  $\leq$  40000PPM)

**FINISH:**

1. Contacts: Gold Flash Plated on Contact Area  
Tin Plated on Solder tails  
Nickel Under Plated Over All
2. Shell: Nickel Plated
3. Rivet: Nickel Plated
4. Board Lock: Tin Plated
5. Screw: Nickel Plated

**SPECIFICATION:**

1. Current Rating: 2 Amp
2. Dielectric Withstanding Voltage: AC 500V r.m.s.
3. Insulation Resistance: 5000M $\Omega$  Min. at DC 500V
4. Contact Resistance: 30m $\Omega$  Max.
5. Operating Temperature: -55°C to 105°C

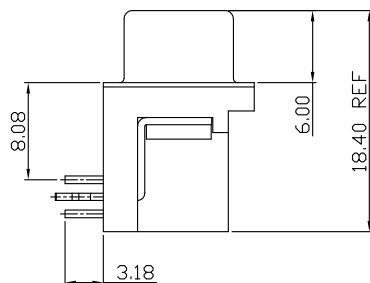
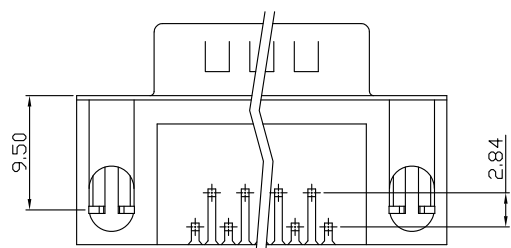

鉗合型

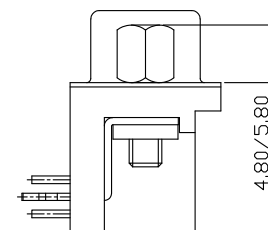

鉗合鎖螺絲型

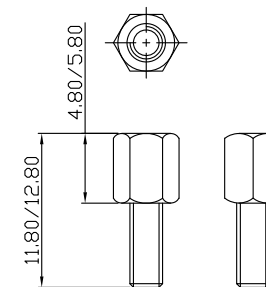

NO. OF POS.	A	B	C
09Pin	30.80	24.99	16.92
15Pin	39.20	33.32	25.25
25Pin	53.04	47.04	38.96
37Pin	69.40	63.50	55.42

僅供參考

**XIAN YI PRECISION CO., LTD.**  
祥益精密股份有限公司

TITLE / 品名: D-Sub 90度 二排公座 (板邊距8.08) Dip Type

核準發行章

PART NO / 料號: D1110-xxM-Rxxxx

APPROVE / 核準	CHECKED / 審查	DRAWING / 繪圖	DRAWING NO / 圖號	UNIT / 單位	☉	X
<i>Kin</i>	<i>Chenrong</i>	<i>Chenrong</i>	K-0D-004-00	mm	SHEET 1 OF 1	

NO.	REV / 版本	圖面僅供參考, 實際尺寸以承認圖為主	2025/12/19
		修訂內容	日期